

Terminal Block Accessories

Double Row - Sub Mounted Marking Strips

Specifications:

- Black XP Phenolic Material, 0.03" thick
- Printed on Top or Bottom Position with Letters or Numbers for Circuit Identification
- Printing Character Size is 1/8 Inch

# of Terminals	Series 1 100/670A GP, 600 GP, 600A GP, 670A RZ	Series 2 200/671 GP, 601 GP, 621 RZ, 671 RZ	Series 3 300/672 GP 602 GP, 672 RZ
1	1.031	1.188	1.531
2	1.406	1.625	2.094
3	1.781	2.063	2.656
4	2.156	2.500	3.219
5	2.531	2.938	3.781
6	2.906	3.375	4.344
7	3.281	3.813	4.906
8	3.656	4.250	5.469
9	4.031	4.688	6.031
10	4.406	5.125	6.594
11	4.781	5.563	7.156
12	5.156	6.000	7.719
13	5.531	6.438	8.281
14	5.906	6.875	8.844
15	6.281	7.313	9.406
16	6.656	7.750	9.969
17	7.031	8.188	10.531
18	7.406	8.625	11.094
19	7.781	9.063	11.656
20	8.156	9.500	12.219
21	8.531	9.938	12.781
22	8.906	10.375	13.344
23	9.281	10.813	13.906
24	9.656	11.250	14.469
25	10.031	11.688	--
26	10.406	12.125	--
27	10.781	12.563	--
28	11.156	13.000	--
29	11.531	13.438	--
30	11.906	13.875	--
31	12.281	--	--
32	12.656	--	--
33	13.031	--	--
34	13.406	--	--
35	13.781	--	--
36	14.156	--	--

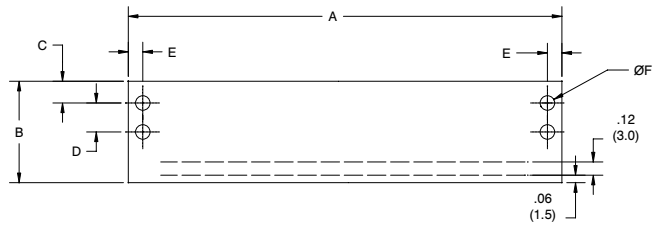

SERIES	B	C	D	E	F
100	1.12	.28	.31	.14	.16
200	1.37	.34	.42	.16	.18
300	1.56	.40	.50	.20	.20
621	1.88	.51	.42	.16	.18

Print Styles

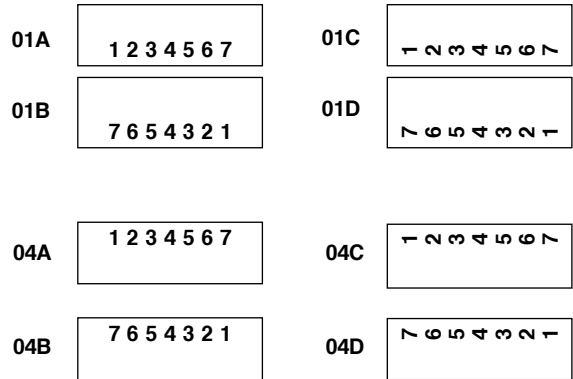

Ordering Code

